



TET ESTEL AS
ESTONIA

June
2013

Series
D161-250
D161-250X

Rectifier Stud-Mounted
Diodes
Type D161-250,
D161-250X

Designed for rectifiers and industrial applications.

Maximum mean forward current					I_{FAV}	250 A		
Maximum repetitive peak reverse voltage					U_{RRM}	1000 ÷ 1800 V		
Reverse recovery time					trr (typ)	22 μs		
U_{RRM} , V	1000	1100	1200	1300	1400	1500	1600	1800
Voltage code	10	11	12	13	14	15	16	18
T_{vj} , °C	- 60 ÷ 175							

MAXIMUM ALLOWABLE RATINGS

Symbols and parameters		Units	D161-250 D161-250X	Conditions	
I_{FAV}	Mean forward current	A	250 577	$T_c=140\text{ °C}$, $T_c=70\text{ °C}$, 180° half-sine wave, 50 Hz	
I_{FRMS}	RMS forward current	A	392	$T_c=140\text{ °C}$	
I_{FSM}	Surge forward current	kA	6,4 7,0	$T_{vj}=175\text{ °C}$ $T_{vj}=25\text{ °C}$	tp=10 ms $U_R=0$
I^2t	Limiting load integral	kA ² s	204 245	$T_{vj}=175\text{ °C}$ $T_{vj}=25\text{ °C}$	
U_{RRM}	Repetitive peak reverse voltage	V	1000÷1800	$T_j \min \leq T_{vj} \leq T_{jM}$ 180° half-sine wave, 50 Hz	
U_{RSM}	Non-repetitive peak reverse voltage	V	1100÷1900	$T_j \min \leq T_{vj} \leq T_{jM}$ 180° half-sine wave tp=10 ms, Single pulse	
T_{stg}	Storage temperature	°C	-60÷80		
T_{vj}	Junction temperature	°C	-60÷175		

CHARACTERISTICS

U_{FM}	Peak forward voltage	V	1,35	$T_{vj}=25\text{ °C}$, $I_{FM}=3,14 I_{FAV}$
$U_{F(TO)}$	Threshold voltage	V	0,72	$T_{vj}=175\text{ °C}$ 1,57 $I_{FAV} < I_F < 4,71 I_{FAV}$
R_T	Forward slope resistance	mΩ	0,56	
I_{RRM}	Repetitive peak reverse current	mA	40	$T_{vj}=175\text{ °C}$, $U_R = U_{RRM}$

CHARACTERISTICS

Symbols and parameters		Units	D161-250 D161-250X	Conditions
Q _{rr}	Recovered charge (typ)	μC	900	T _{vj} =175°C, I _F =250A, U _R =100V di _R / dt = 10A/μs
t _{rr}	Reverse recovery time (typ)	μS	22	
I _{rrm}	Peak reverse recovery current (typ)	A	82	
R _{thjc}	Thermal resistance junction to case	°C/W	0,12	Direct current

ORDERING

	D	161	250	X	14	
	1	2	3	4	5	

1. Diode
2. Design version
3. Mean forward current, A
4. Reverse polarity (cathode stud mounted), without X-normal polarity
5. Voltage code (14 = 1400 V)

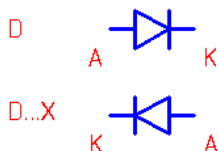
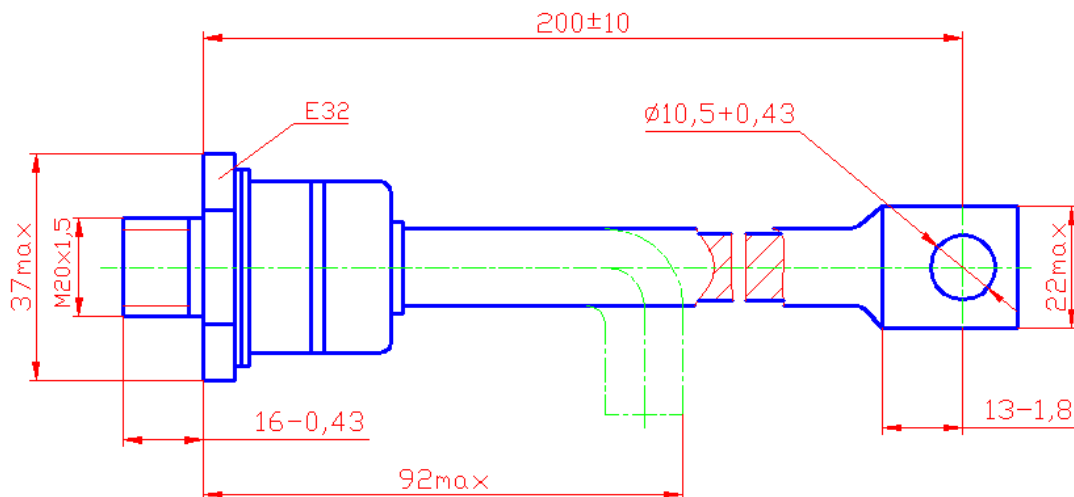

Tightening torque: 24 ÷ 36 Nm
Weight : 280 grams

Diodes can be supplied in the packages with the framework of 16x1,5 in accordance to the customer.